

Indirect-Drive Right-Angle Speed Reducers



- Reversible rotation
 - All-position mounting, except input shaft down; optional bases available on page 87
 - Shipped with Klübersynth UH1 6-460 gear oil 34K212
 - Double-lip, spring-loaded oil seals; large, prefilled oil sump
- Interchangeable with most Grove (Flexaline) and Ohio (Uniline) models. The output shaft on single-output models can be field-converted from standard left-hand to right-hand extension. Worm is

thread-rolled and alloy-hardened for higher strength and low power loss. Left-hand facing input shaft. Input shaft has ball bearings and output shaft has tapered roller bearings. Cast-iron housing. Flange coupling kits to adapt NEMA 56C-145TC motors to Dayton right-angle speed reducers sold separately; see below.

FLANGE COUPLING KITS

- Bolt circle dia.: 5.88"
- Mounting hardware and shaft coupling included

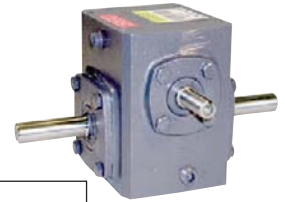
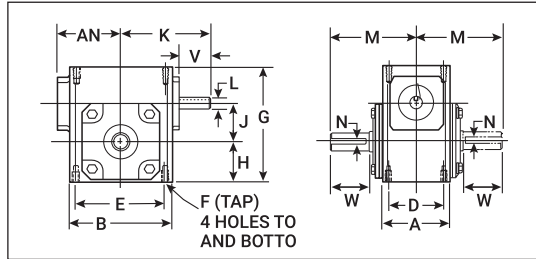

6Z419

Worm Center Distance	Dimensions										Shaft Dimensions						
	A	B	D	E	F	G	H	J	AN	K	L	Input Shaft Keyway	M	N	Output Shaft Keyway		
1.00"	2.50"	3.25"	1.69"	2.62"	1/4-20"	3.63"	1.31"	1.00"	1.63"	2.88"	0.375"	0.81"	0.093 x 0.75"	2.88"	0.499"	1.19"	0.125 x 0.64"
1.33"	3.50"	4.25"	3.00"	3.00"	1/4-20"	4.94"	1.75"	1.33"	2.13"	3.91"	0.500"	1.31"	0.125 x 1.38"	4.38"	0.625"	2.08"	0.188 x 1.25"
1.75"	3.69"	5.50"	2.75"	4.19"	5/16-18"	5.75"	2.06"	1.75"	2.75"	4.88"	0.625"	1.56"	0.188 x 1.50"	4.31"	0.875"	1.78"	0.188 x 1.14"
2.06"	3.81"	6.00"	3.00"	4.75"	5/16-18"	6.38"	2.28"	2.06"	3.00"	5.13"	0.625"	1.56"	0.188 x 1.50"	4.69"	1.000"	2.09"	0.250 x 1.32"
2.62"	4.44"	7.38"	3.38"	6.38"	3/8-16"	8.00"	2.94"	2.63"	3.69"	6.31"	0.750"	2.00"	0.188 x 1.63"	5.63"	1.250"	2.62"	0.250 x 1.93"

Nom. Output RPM*	Worm Center Distance	Overhung Load	Nom. Ratio	Max. Input HP	Max. Output Torque	DOUBLE OUTPUT		SINGLE OUTPUT		Worm Center Distance	Input Motor Frame Size	Overall Length Reducer & Flange	Motor Coupling Bore	Reducer Coupling Bore	Reducer Coupling Keyway	Item No.
						Item No.	Item No.	Item No.	Item No.							
29	1.33 in	275 lb	60:1	0.25 hp	209.0 in-lb	6Z419	6Z439	6Z439	6Z439	1.33 in	56C	7.34 in	0.63 in	0.5 in	0.13 x 0.06"	3A701
	1.75 in	700 lb	60:1	0.3 hp	415 in-lb	6Z420	6Z440	6Z440	6Z440	1.75 in	56C	10.28 in	0.63 in	0.63 in	0.19 x 0.09"	6HJ79
	2.06 in	875 lb	60:1	0.5 hp	636 in-lb	6Z421	6Z441	6Z441	6Z441	2.06 in	143TC/145TC	10.28 in	0.88 in	0.63 in	0.19 x 0.09"	6HJ80
	2.62 in	1,300 lb	60:1	0.75 hp	1,021 in-lb	6Z422	6Z442	6Z442	6Z442	2.62 in	56C	11.31 in	0.63 in	0.63 in	0.19 x 0.09"	6HJ81
44	2.06 in	875 lb	40:1	0.5 hp	492 in-lb	6Z424	6Z449	6Z449	6Z449	2.06 in	143TC/145TC	11.31 in	0.88 in	0.63 in	0.19 x 0.09"	6HJ82
	2.62 in	1,300 lb	40:1	1 hp	1,028 in-lb	6Z425	6Z450	6Z450	6Z450	2.62 in	56C	13.16 in	0.63 in	0.75 in	0.19 x 0.09"	3A706
58	1.75 in	700 lb	30:1	0.5 hp	401 in-lb	6Z426	6Z453	6Z453	6Z453	1.75 in	143TC/145TC	13.16 in	0.88 in	0.75 in	0.19 x 0.09"	3A707
	2.06 in	875 lb	30:1	0.75 hp	610 in-lb	6Z427	6Z454	6Z454	6Z454	2.06 in	56C	10.28 in	0.63 in	0.63 in	0.19 x 0.09"	6HJ79
	2.62 in	1,300 lb	30:1	1.5 hp	983 in-lb	6Z428	6Z455	6Z455	6Z455	2.62 in	143TC/145TC	13.16 in	0.88 in	0.75 in	0.19 x 0.09"	6HJ80
88	1.75 in	700 lb	20:1	0.75 hp	436 in-lb	6Z429	6Z457	6Z457	6Z457	1.75 in	56C	11.31 in	0.63 in	0.63 in	0.19 x 0.09"	6HJ81
	2.06 in	875 lb	20:1	1 hp	586 in-lb	6Z430	6Z458	6Z458	6Z458	2.06 in	143TC/145TC	13.16 in	0.88 in	0.75 in	0.19 x 0.09"	6HJ82
350	1.0 in	150 lb	5:1	0.5 hp	79.0 in-lb	6Z436	6Z469	6Z469	6Z469	1.0 in	56C	7.34 in	0.63 in	0.5 in	0.13 x 0.06"	3A701

* @ 1750 rpm.

Indirect-Drive Right-Angle Single-Shaft Speed Reducers



- All-position mounting (bases sold separately)
- Shipped without oil, use 34K212

Heavy-duty worm gear speed reducers have value-engineered features for flexible installation, long life, and simplified maintenance. Integral input worm and shaft are made from case-hardened alloy steel. Oversized ball and roller bearings assure maximum performance. Fine-grained cast-iron housing and output shaft (left-hand facing input shaft).

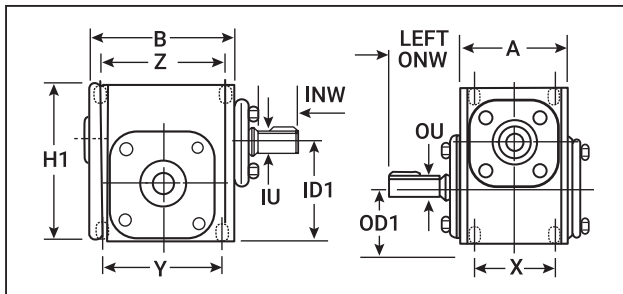

1L244

Worm Center Dist.	Overhung Load	Dimensions							Shaft Dimensions						
		A	B	H1	X	Y	Z	ID1	INW	Input Shaft I.U.	Keyway	OD1	Output Shaft ONW	OU	Keyway
1.00"	150 lbs.	2.50"	3.25"	3.63"	1.69"	2.63"	2.63"	2.31"	0.81"	0.375"	3/32 x 3/8"	1.31"	1.19"	0.500"	1/8 x 3/8"
1.33"	200 lbs.	2.88"	4.25"	4.66"	2.00"	3.25"	3.25"	3.05"	1.31"	0.500"	3/16 x 3/8"	1.72"	2.00"	0.625"	3/16 x 1"
1.54"	300 lbs.	3.69"	5.13"	5.38"	2.75"	4.19"	4.19"	3.45"	1.56"	0.625"	3/16 x 1/2"	1.91"	1.78"	0.750"	3/16 x 1"
1.75"	500 lbs.	3.69"	5.50"	5.75"	2.75"	4.19"	4.19"	3.81"	1.56"	0.625"	3/16 x 1/2"	2.06"	1.78"	0.875"	3/16 x 1"
2.06"	700 lbs.	3.81"	6.00"	6.38"	2.88"	5.00"	5.00"	4.34"	1.56"	0.625"	3/16 x 1/2"	2.28"	2.09"	1.000"	1/4 x 1 1/4"
2.38"	900 lbs.	4.06"	6.38"	6.94"	2.88"	5.00"	5.00"	4.88"	2.00"	0.750"	3/16 x 1"	2.50"	2.37"	1.125"	1/2 x 1 1/4"
2.62"	1000 lbs.	4.44"	7.38"	8.00"	3.38"	6.38"	6.38"	5.56"	2.00"	0.750"	3/16 x 1"	2.94"	2.62"	1.125"	1/4 x 1 1/4"

Nom. Output RPM*	Worm Center Distance	Nom. Ratio	Max. Input HP	Max. Output Torque	Mfr. Model	Item	Nom. Output RPM*	Worm Center Distance	Nom. Ratio	Max. Input HP	Max. Output Torque	Mfr. Model	Item	Worm Center Distance	Base Width	Base Length	Mfr. Model	Item No.
29	2.38 in	60:1	0.5 hp	772 in-lb	724-60-G	1L347	88	1.0 in	20:1	0.25 hp	138.0 in-lb	710-20-G	1L247	1.0 in	3.69 in	4.63 in	87874	4NY17
	1.0 in	50:1	0.16 hp	153.0 in-lb	710-50-G	1L244		1.33 in	20:1	0.3 hp	197.0 in-lb	713-20-G	1L262	1.33 in	4.19 in	5.38 in	56437	4YA78
35	1.33 in	50:1	0.16 hp	198.0 in-lb	713-50-G	1L265	117	1.54 in	20:1	0.5 hp	302.0 in-lb	715-20-G	1L278	1.54 in	5.44 in	6.44 in	56438	4YA79
	1.54 in	50:1	0.25 hp	306.0 in-lb	715-50-G	1L275		2.38 in	20:1	1.5 hp	948 in-lb	724-20-G	1L341	1.75 in	5.69 in	7.0 in	56439	4YA80
44	2.38 in	50:1	0.75 hp	1,014 in-lb	724-50-G	1L348	175	2.38 in	15:1	2 hp	990 in-lb	724-15-G	1L342	2.06 in	5.94 in	7.75 in	56440	4YA81
	1.0 in	40:1	0.16 hp	148.0 in-lb	710-40-G	1L245		2.62 in	15:1	2 hp	994 in-lb	726-15-G	1L353	2.38 in	6.19 in	8.5 in	56441	4YA82
58	1.33 in	40:1	0.16 hp	165.0 in-lb	713-40-G	1L259	350	1.54 in	10:1	1 hp	330.0 in-lb	715-10-G	1L280	2.62 in	6.66 in	9.63 in	56442	4YA83
	1.54 in	40:1	0.3 hp	342.0 in-lb	715-40-G	1L276		1.75 in	10:1	1.5 hp	499 in-lb	718-10-G	1L301	Description				
70	2.38 in	40:1	0.75 hp	837 in-lb	724-40-G	1L343	175	2.38 in	10:1	2 hp	672 in-lb	724-10-G	1L345	Mfr. Model				
	1.54 in	30:1	0.3 hp	274.0 in-lb	715-30-G	1L277		2.62 in	10:1	3 hp	1,024 in-lb	726-10-G	1L354	Item No.				
58	2.38 in	30:1	1 hp	902 in-lb	724-30-G	1L344	350	1.54 in	5:1	1.5 hp	254.0 in-lb	715-5-G	1L281	Gear Oil				
	1.0 in	25:1	0.3 hp	238.0 in-lb	713-25-G	1L261		1.75 in	5:1	2 hp	338.0 in-lb	718-5-G	1L302	Synthetic Gear Oil, H1				
70	2.38 in	30:1	1 hp	902 in-lb	724-30-G	1L344	350	2.06 in	5:1	2 hp	338.0 in-lb	721-5-G	1L310	Food Grade, 1 qt				
	1.0 in	25:1	0.3 hp	238.0 in-lb	713-25-G	1L261		2.38 in	5:1	3 hp	508 in-lb	724-5-G	1L346	65159				
70	2.38 in	30:1	1 hp	902 in-lb	724-30-G	1L344	350	2.62 in	5:1	3 hp	508 in-lb	726-5-G	1L355	34K212				

* @ 1750 rpm.