

1-800-GRAINGER (472-4643)

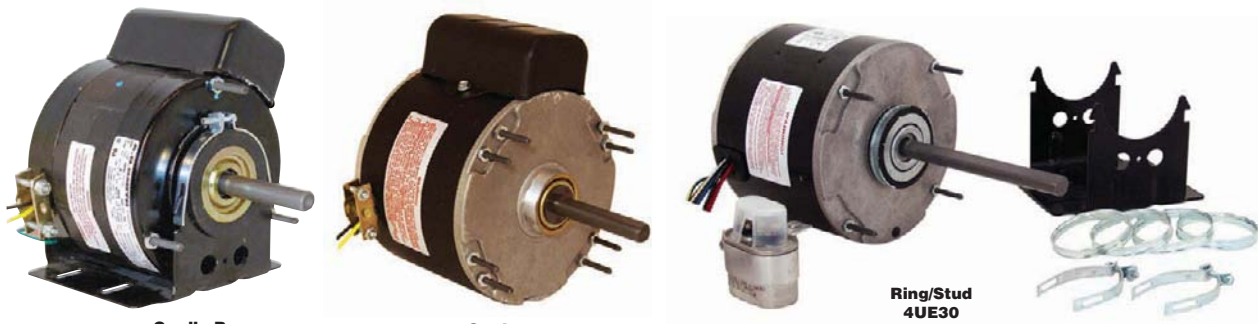

**Cradle Base  
4LY82**

**Stud  
4LY86**

**Ring/Stud  
4UE30**

## Permanent Split Capacitor Unit Heater Motors



- Enclosure: totally enclosed air-over
- Rotation: CW/CCW

- Thermal protection: auto
- Service factor: 1.0
- Duty: continuous

Provide smooth and softer startups for fans and blowers that must gradually come up to speed after startup. They have a capacitor that decreases the amount of power consumed for a given load. Use with unit heaters and other shaft-mounted fan and blower equipment in dusty, dirty, noncombustible environments. Cradle base models have 1" x 5/16" mounting slots in a 1 1/16" x 3 1/2" pattern.

HP	Nameplate RPM	Voltage	Full Load Amps	Ins. Class	Motor Mounting Type	Bearings	Body Dia.	Shaft Dia.	Shaft Length	Length Less Shaft	Ring Dia.	Ring to Ring Center	Stud Pattern	Max. Ambient Temp.	Item No.
<b>1-Speed, 42Y Frame</b>															
1/8	1,075	115V AC	2.1	A	Cradle Base	Sleeve	5 in	1/2 in	2 3/8 in	4 1/16 in	2 1/2 in	4 9/16 in	—	40°C	4LY82
<b>1-Speed, 48Y Frame</b>															
1/8	1,075	115V AC	2.00	B	Stud	Ball	5 5/8 in	1/2 in	3 3/4 in	5 1/8 in	—	—	3 3/8" x 3 3/8" SE, 4 1/2" x 2 3/8" SE	60°C	4LY86
	1,075	115V AC	2.00	B	Stud	Ball	5 5/8 in	1/2 in	3 3/4 in	5 1/8 in	—	—	3 3/8" x 3 3/8" OSE, 4 1/2" x 2 3/8" SE	60°C	4LY94
	1,075	115V AC	2.00	B	Ring/Stud	Ball	5 5/8 in	1/2 in	5 1/2 in	5 1/8 in	2 1/2 in	4 1 1/16 in	3 3/8" x 3 3/8" SE, 4 1/2" x 2 3/8" SE	60°C	4UE26 †
1/4	1,140	115/208-230V AC	3.1, 1.60	B	Cradle Base	Ball	5 5/8 in	1/2 in	5 5/8 in	7 1/4 in	2 1/4 in	6 7/8 in	3 3/8" x 3 3/8" SE	60°C	4HCJ2
	1,075	115V AC	4.1	B	Stud	Ball	5 5/8 in	1/2 in	3 in	5 1/4 in	—	—	3 3/8" x 3 3/8" SE, 4 1/2" x 2 3/8" SE	40°C	4LY90
	1,075	115V AC	4.1	B	Ring/Stud	Ball	5 5/8 in	1/2 in	5 1/2 in	5 1/4 in	2 1/2 in	4 1 1/16 in	3 3/8" x 3 3/8" SE, 4 1/2" x 2 3/8" SE	40°C	4UE27 †
1/2	1,075	208-230V AC	1.10	B	Ring/Stud	Ball	5 5/8 in	1/2 in	5 1/2 in	5 1/4 in	2 1/4 in	4 1 1/16 in	3 3/8" x 3 3/8" SE	40°C	4UE30 †
	1,075	115V AC	5.0	A	Stud	Ball	5 5/8 in	1/2 in	3 in	5 5/8 in	2 1/2 in	5 3/8 in	3 3/8" x 3 3/8" SE, 4 3/8" x 2 3/8" SE	40°C	4HC48
	1,075	115V AC	5.0	A	Ring/Stud	Ball	5 5/8 in	1/2 in	5 1/2 in	5 5/8 in	2 1/2 in	5 3/8 in	3 3/8" x 3 3/8" SE, 4 1/2" x 2 3/8" SE	40°C	4UE28 †
1/2	1,140	115/208-230V AC	5.6, 2.8	B	Cradle Base	Ball	5 5/8 in	1/2 in	5 1/2 in	8 1/4 in	2 1/4 in	7 7/8 in	3 3/8" x 3 3/8" SE	60°C	4HC47
<b>2-Speed, 48Y Frame</b>															
1/8	1,100	115V AC	4.3-1.80	B	Ring/Stud	Ball	5 5/8 in	1/2 in	5 in	6 1/8 in	2 1/4 in	5 1 1/16 in	3 3/8" x 3 3/8" SE	40°C	4LY92 *
1/8	1,100	230V AC	1.70-1.10	B	Ring/Stud	Ball	5 5/8 in	1/2 in	5 in	6 1/8 in	2 1/4 in	5 1 1/16 in	3 3/8" x 3 3/8" SE	40°C	4LY88 *

\* Includes split rings to increase ring dia. from 2 1/4" to 2 5/8". † Unassembled cradle base.



4MA18



4MA22



4MA30



## 1-Phase Flange-Mount Oil Burner Motors

- Thermal protection: manual
- Max. ambient temp.: 40°C

These motors power the fan and oil pump inside an oil burner unit. They have a NEMA oil burner flange for direct coupling to domestic oil burners and feature quick-change reversing terminals. Capacitor-start motors include capacitor.

HP	Nameplate RPM	Frame	Rotation	Voltage	Full Load Amps	Service Factor	Motor Design	Bearings	Brand	Mfr. Model	Item No.
<b>Open, Ventilated Flange</b>											
1/4	3,450	48N	CW/CCW	115V AC	3.4	1	Split-Phase	Sleeve	Century	EL2022	4MA18
1/2	1,725	48N	CW/CCW	115V AC	4.3	1	Split-Phase	Sleeve	Century	OL2034	4MA20
<b>Open Air-Over, Ventilated Flange</b>											
1/8	3,450	48MZ	CW/CCW	115V AC	2.7	1	Split-Phase	Ball	Marathon	048S34S2005	454X81
1/8	3,450	48N	CW/CCW	115/230V AC	3.0/1.50	1	Capacitor-Start	Ball	Marathon	048C34S24	454X83
1/4	3,450	48NZ	CW/CCW	115V AC	4.2	1	Split-Phase	Sleeve	Marathon	048S34S2003	454X84
1/4	1,725	48N	CW/CCW	115V AC	3.9	1	Split-Phase	Ball	Marathon	048S17S25	454X85
<b>Open Dripproof, Nonventilated Flange</b>											
1/8	3,450	48N	CW/CCW	115/230V AC	4.2/2.1	1.35	Capacitor-Start	Sleeve	Century	OL1032D	4MA22
1/8	3,450	48NZ	CW/CCW	115/208-230V AC	5.6/2.8-2.7	1	Capacitor-Start	Ball	Marathon	048C34D2024	454X87
1/2	3,450	48N	CW/CCW	115/230V AC	6.4/3.2	1.25	Capacitor-Start	Sleeve	Century	OL1052DS	4MA24
1/2	3,450	48NZ	CW/CCW	115/208-230V AC	7.4/3.7-3.5	1	Capacitor-Start	Ball	Marathon	048C34D2028	454X90
<b>Totally Enclosed Air-Over, Nonventilated Flange</b>											
1/8	1,725	48N	CW/CCW	115V AC	4.3	1	Split-Phase	Sleeve	Century	EL2034	4MA30
<b>Totally Enclosed Nonventilated, Nonventilated Flange</b>											
1/8	1,725	48N	CW/CCW	115V AC	2.6	1	Split-Phase	Ball	Marathon	048S17T286	454X79
1/8	3,450	48N	CW/CCW	115V AC	2.4	1	Split-Phase	Ball	U.S. Motors	2097	55ML64
1/8	1,725	48NZ	CW/CCW	115V AC	2.9	1	Split-Phase	Ball	Marathon	048S17T290	454X82
<b>Totally Enclosed Nonventilated, Ventilated Flange</b>											
1/8	3,450	48N	CW/CCW	115V AC	4.9	1	Split-Phase	Sleeve	Marathon	5KH33GN5014U	454X88

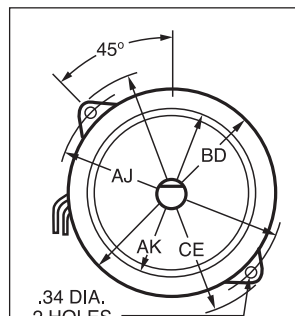

.34 DIA.  
2 HOLES

NEMA 48M, and 48N Flange Mount Dimensions: Oil Burner Motors	
48M	48N
AJ	6 3/4" 7 1/4"
BD	6 1/4" Max. 7" Max.
AK	5 1/2" 6 3/8"
CE	7 3/4" Max. 8 1/4" Max.

**IMPORTANT MOTOR INFORMATION** | Refer to pages 3-7 for selection guidelines, standardized dimensions, thermal protection information, UL 507 Standard location information, NEMA & IEC guidelines, energy legislation information, and terminology.