



Belt-Drive Wall-Mount Cabinet Exhaust and Supply Fans

- Fully assembled fan packages for through-the-wall installation
- Motors: open dripproof
- Regreasable cast pillow block ball bearings
- Max. inlet/ambient temp.: 104°F
- Variable pitch, adjustable motor pulley optimizes fan performance

Belt-drive fans are designed for commercial/industrial applications that require delivery of high volumes of air at low static pressures. Air handling-quality bearings meet a minimum of L10-100,000 hours. Features include galvanized steel fan panel, fabricated steel propeller, and bolted cabinets. Exhaust damper blade is top-pivoting gravity return; supply damper blade is bottom-pivoting spring return. Wall-mounting angles included.



1AHB6

Blade Dia.	CFM Air Delivery @ Static Pressure Shown*			Fan Voltage	Phase	Full Load Amps	Exhaust/Supply Fan		Sones @ 0.125" SP	Dim. A	Dim. B	Item No.	
	0.000"	0.125"	0.250"				Motor HP	Max. BHP†					Fan RPM
Exhaust Fans													
24 in	5.056	4.097	3.100	115/208-230V AC	1	8.0/4.0-4.0	1/2	0.58	765	12.9	28 1/4 in	34 1/2 in	1AHB6
	5.796	4.950	4.165	208-230/460V AC	3	2.8-2.7/1.4	3/4	0.86	877	16.0	28 1/4 in	34 1/2 in	1AHB7
	8.542	7.110	5.297	115/208-230V AC	1	11.0/5.5-5.4	3/4	0.87	651	16.2	34 1/4 in	34 1/2 in	1AHB8
30 in	9.408	8.131	6.633	208-230/460V AC	3	3.5-3.6/1.8	1	1.18	717	18.9	34 1/4 in	34 1/2 in	1AHB9
	12.365	10.512	7.712	115/208-230V AC	1	13.0/7.0-7.0	1	1.16	534	16.3	40 1/4 in	34 1/2 in	1AHD1
	14.148	12.611	10.527	208-230/460V AC	3	4.6-4.2/2.1	1 1/2	1.73	611	21	40 1/4 in	34 1/2 in	1AHD2
42 in	14.346	12.157	7.848	115/208-230V AC	1	13.0/7.0-7.0	1	1.15	422	17.5	46 1/4 in	34 1/2 in	1AHD3
	16.386	14.520	11.551	208-230/460V AC	3	4.6-4.2/2.1	1 1/2	1.73	482	21	46 1/4 in	34 1/2 in	1AHD4
	20.669	19.312	17.640	208-230/460V AC	3	15.4-14.2/7.1	3	3.45	608	24	46 1/4 in	34 1/2 in	6LFC2
	24.477	23.361	22.019	208-230/460V AC	3	13.6-12.8/6.4	5	5.75	720	62	46 1/4 in	34 1/2 in	6LFC3
	18.435	13.085	8.238	115/208-230V AC	1	13.0/7.0-7.0	1	1.15	354	14.8	54 1/4 in	36 1/2 in	1AHD5
48 in	23.174	19.870	15.154	208-230/460V AC	3	6.0-5.6/2.9	2	2.31	445	20	54 1/4 in	36 1/2 in	1AHD6
	26.611	23.913	19.100	208-230/460V AC	3	15.4-14.2/7.1	3	3.45	511	38	54 1/4 in	36 1/2 in	6LFC4
	31.506	29.520	26.636	208-230/460V AC	3	13.6-12.8/6.4	5	5.75	605	53	54 1/4 in	36 1/2 in	6LFC5
54 in	35.881	34.002	31.574	208-230/460V AC	3	13.6-12.8/6.4	5	5.53	518	41	60 1/4 in	39 1/2 in	1AHD7
Supply Fans													
24 in	4.988	4.206	3.321	115/208-230V AC	1	8.0/4.0-4.0	1/2	0.58	778	13.6	28 1/4 in	34 1/2 in	1AJA7
30 in	9.403	8.310	6.536	115/208-230V AC	1	13.0/7.0-7.0	1	1.15	720	19.3	34 1/4 in	34 1/2 in	1AJA8
36 in	13.913	12.435	10.110	208-230/460V AC	3	4.6-4.2/2.1	1 1/2	1.73	619	21	40 1/4 in	34 1/2 in	1AJA9
48 in	23.177	19.858	15.591	208-230/460V AC	3	6.0-5.6/2.9	2	2.31	440	19.9	54 1/4 in	36 1/2 in	1AJB1
54 in	36.830	34.067	31.251	208-230/460V AC	3	13.6-12.8/6.4	5	5.65	520	42	60 1/4 in	39 1/2 in	1RBD8

* Performance certified is for installation type A: free inlet, free outlet. † Power rating (BHP) does not include transmission losses. Performance ratings include the effects of bird screen and damper in the air stream. # The sound ratings shown are loudness values in fan zones at 5 ft. (1.5m) in a hemispherical free field calculated per AMCA Standard 301. Values shown are for installation type A: free inlet hemispherical sone levels.

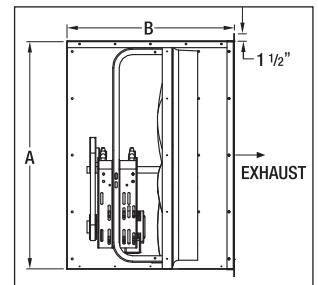

Reversible Belt-Drive Exhaust/Supply Fans



- Mount: vertical
- Regreasable cast pillow block bearings
- Max. inlet/ambient temp.: 104°F
- Variable-pitch, adjustable motor pulley optimizes fan performance

Designed for commercial and industrial applications requiring both supply and exhaust air. Fans feature 6-blade cast-aluminum propellers and rigid drive-frame rails. Motor, sheaves, bushings, belts, and reversing switch are packed separately when complete fan with drive package is ordered. Air handling-quality bearings meet a min. of L10-100,000 hr.

Note: OSHA-complying guards are required when a fan is installed within 8 ft. of floor, working level, or within reach of personnel. Review OSHA codes and UL standards.

4YGA3

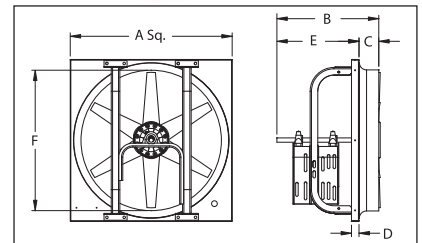

Blade Dia.	RECOMMENDED ACCESSORIES						Exhaust/Supply Fan Motor HP	Max. BHP†	Fan RPM	FANS COMPLETE WITH DRIVE PACKAGE**					FAN WITHOUT MOTOR & DRIVE PKG** Item No.			
	A	B	Dimensions (in)		E	F				Wall Housing Item No.	Weather Hood Item No.	Fan Guard Item No.	Wall Collar Item No.	Motorized Damper Item No.		Totally Enclosed 115/230V, 60 Hz	Open Dripproof 115/230V, 60 Hz	Totally Enclosed 208/440V, 60Hz
30 in	34	21 1/2	5 1/4	1	16 1/4	30 3/8	3FKF9	1WBW1	1WBU4	1WBV2	3C728	7AP95	7AP96	7AP97	7AP98	4YGA3		
36 in	40	22	6	1	16	36 3/8	3FKG1	1WBW2	1WBU5	1WBV3	3C729	7AR07	7AR08	7AR09	7AR10			
48 in	54	23 1/2	7	2	16 1/2	48 1/2	3FKG3	1WBW4	1WBU7	1WBV5	3C731	7AR11	7AR12	7AR13	7AR14			
												7AR15	7AR16	7AR17	7AR18			
												7CK38	7CK39	7AR19	7CK40			
36 in												7CK41	7CK42	7AR20	7CK43	1WDN2		
												7CK44	7CK45	7AR21	7CK46			
												7CK47	7CK48	7AR22	7CK49			
												7CK50	7CK51	7AR23	7CK52			
												7AR24	7AR25	7AR26	7AR27			
48 in														7AR28	7AR29	4YGA4		
														7AR30	7AR31			
														7AR32	7AR33			
														7AR34	7AR35			
														7AR36	7AR37			
														7AR38	7AR39			
														7AR40	7AR41			
													7AR42	7AR43				
													7AR44	7AR45				
													7AR46	7AR47	7AR48	7AR49	7AR50	7AR51

* Performance is for exhaust fan installation type A: free inlet, free outlet. Supply fan performance is approx. 20% less for each horsepower (HP). † Power rating (BHP) does not include transmission losses. Performance ratings do not include the effects of appurtenances (accessories). The sound ratings shown are loudness values in fan zones at 5 ft. (1.5m) in a hemispherical free field. Values are for installation type A: free inlet sone levels. ** Drive package consists of appropriate motor, belt, and sheaves to obtain the performance listed.