

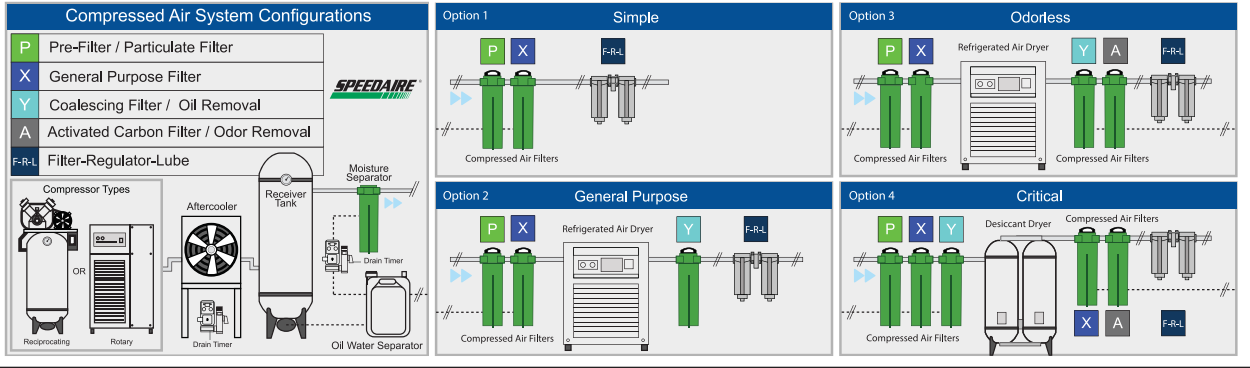

Compressed Air System Configurations



4GNL4

Condensate Separators



Feature a centrifugal airflow pattern that helps remove bulk contaminants from the compressed air stream. Low pressure drop. Separators equipped with auto drain automatically discharge condensate and dirt.

Note: For additional sizes, go to Grainger.com and search by "Condensate Separators".

NPT Size	Max. Flow CFM @ 100 psi	Max. Pressure (psi)	Max. Temp. (°F)	H. (in.)	Dia.	Auto Drain Stock No.	Brand	Mfr. Model	FILTER Item No.	WALL BRACKET Item No.
¼ in	15	235 psi	176 °F	13.2 in	4	Included	Speedaire	4GNL3	4GNL3	35GM64
	60	235 psi	176 °F	13.2 in	4	Included	Speedaire	4GNL4	4GNL4	35GM65
½ in	50	200 psi	150 °F	7.34 in	3.35	Included	Wilkerson	WSA-04-FMO	5Z771	—
	120	235 psi	176 °F	13.2 in	4.8	Included	Speedaire	4GNL5	4GNL5	35GM65
¾ in	100	200 psi	150 °F	10 in	4.625	Included	Wilkerson	WSA-06-FMO	5Z614	—
	175	235 psi	176 °F	13.2 in	4.8	Included	Speedaire	4GNL6	4GNL6	35GM65
	120	200 psi	150 °F	10 in	4.625	Included	Wilkerson	WSA-08-FMO	5Z615	—
	233	230 psi	175 °F	10.875 in	5.125	5Z617	Wilkerson	WSO-08-000B	1AGJ4	—
1 in	350	235 psi	176 °F	13.2 in	4.8	Included	Speedaire	4GNL7	4GNL7	35GM66
	750	250 psi	175 °F	16.96 in	8.22	4ZK14	Speedaire	4ZL13	4ZL13	—
	742	230 psi	175 °F	17 in	6.75	5Z617	Wilkerson	WSO-08-000B	1AGJ5	—
	700	235 psi	176 °F	22 in	7.2	Included	Speedaire	4GNL8	4GNL8	35GM66
1½ in	750	250 psi	175 °F	16.96 in	8.22	4ZK14	Speedaire	4ZL15	4ZL15	—
	742	230 psi	175 °F	17 in	6.75	5Z620	Wilkerson	WSO-0C-000B	1AGJ6	—
	1,300	235 psi	176 °F	28.8 in	10	Included	Speedaire	4GNL9	4GNL9	35GM68
Description										Item No.
Accessory										4GNN2
Float Drain, Replacement for Nos. 4GNL3 to 4GNL9										



> Hankison® Air/Liquid Bypass Valve

Service components without shutting down the system; simply push 1 button to change modes. Push-button can be locked in place to make valve tamperproof. Inlet and outlet fittings are compression type with rubber ferrule. Ideal for most brands of refrigerated dryers, 5 to 15 cfm. Can be used with liquid and gases compatible with nylon, Buna N, and brass.

Inlet Port	Outlet Port	Max. Operating Temp.	Mfr. Model	Item No.
¾" O.D.	¾" O.D.	120 °F	1701-2	5Z777



38XT51

SPEEDAIRE® High-Pressure Compressed Air Filters

■ Max. pressure: 725 psi

Rugged filters are constructed of heavy-duty, no-weld, fully anodized aluminum. Include a manual drain. Filters with a max. pressure of 5075 psi are available on Grainger.com.

Connection Size	Max. Flow	Pre-Filter, 5 Micron	Gen. Purpose, 1 Micron	Oil Removal, 0.01 Micron	Activated Carbon, 0.01 Micron	ELEMENT, Pre-Filter, 5 Micron	ELEMENT, Gen. Purpose, 1 Micron	ELEMENT, Oil Removal, 0.01 Micron	ELEMENT, Activated Carbon, 0.01 Micron
		Item No.	Item No.	Item No.	Item No.	Item No.	Item No.	Item No.	Item No.
¼ in NPT	42 cfm	38XT68	38XT34	38XR64	38XR89	38XR98	38XR74	38XT36	38XR48
½ in NPT	125 cfm	38XT19	38XT23	38XT51	38XR57	38XT15	38XR35	38XR91	38XR81
¾ in NPT	250 cfm	38XR41	38XT25	38XT44	38XR52	38XR97	38XR86	38XR75	38XT75
	350 cfm	38XR84	38XT04	38XT74	38XR50	38XR82	38XT66	38XT30	38XT43
1 in NPT	500 cfm	38XR99	38XR34	38XR92	38XT13	38XT73	38XR77	38XT24	38XT69
	940 cfm	38XR53	38XT62	38XT38	38XR96	38XT07	38XR66	38XR60	38XT12
1½ in NPT	1,470 cfm	38XT42	38XR51	38XT14	38XT08	38XR72	38XT50	38XR95	38XT29
2½ in NPT	1,765 cfm	38XR55	38XT64	38XR37	38XT03	38XT59	38XR62	38XR38	38XR73